

CURVE	DELTA	LENGTH	RADIUS	TAN
C1	91.4311°	40.02'	25.00'	20.51'
C2	86.0901°	37.56'	25.00'	19.51'

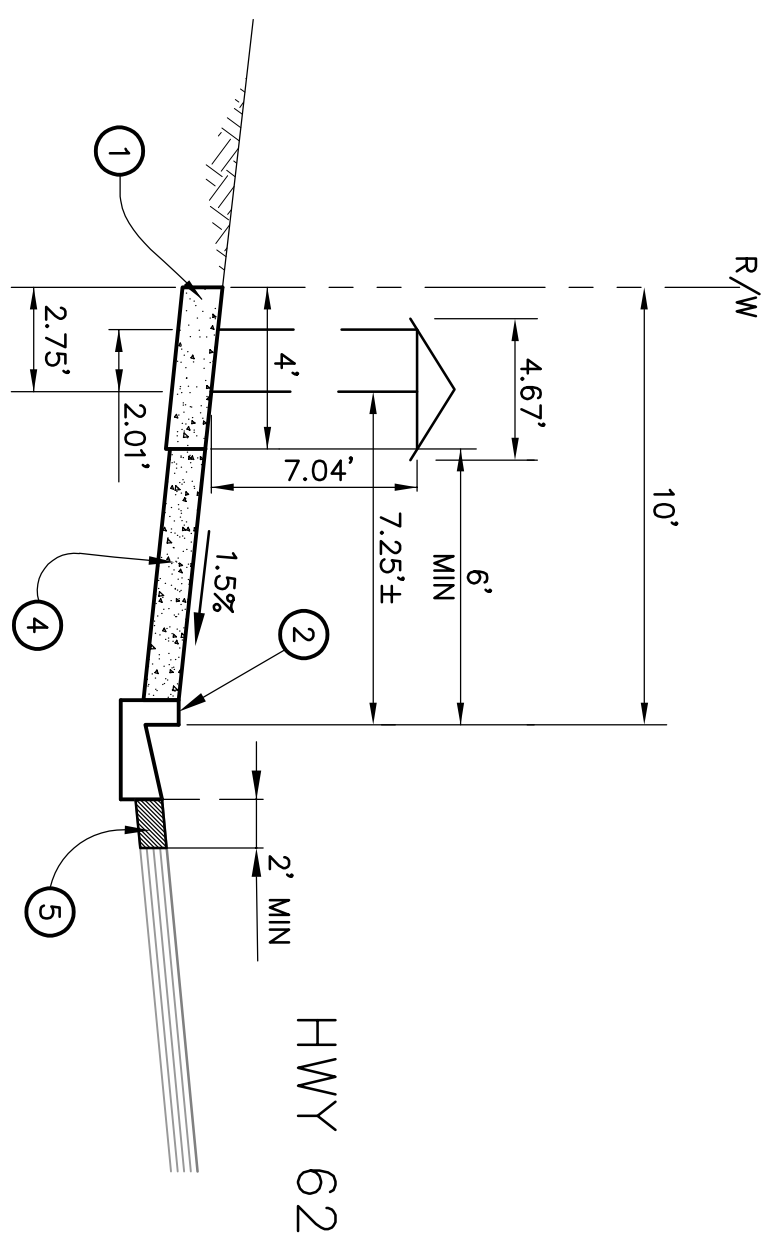

SECTION A-A
NOT TO SCALE

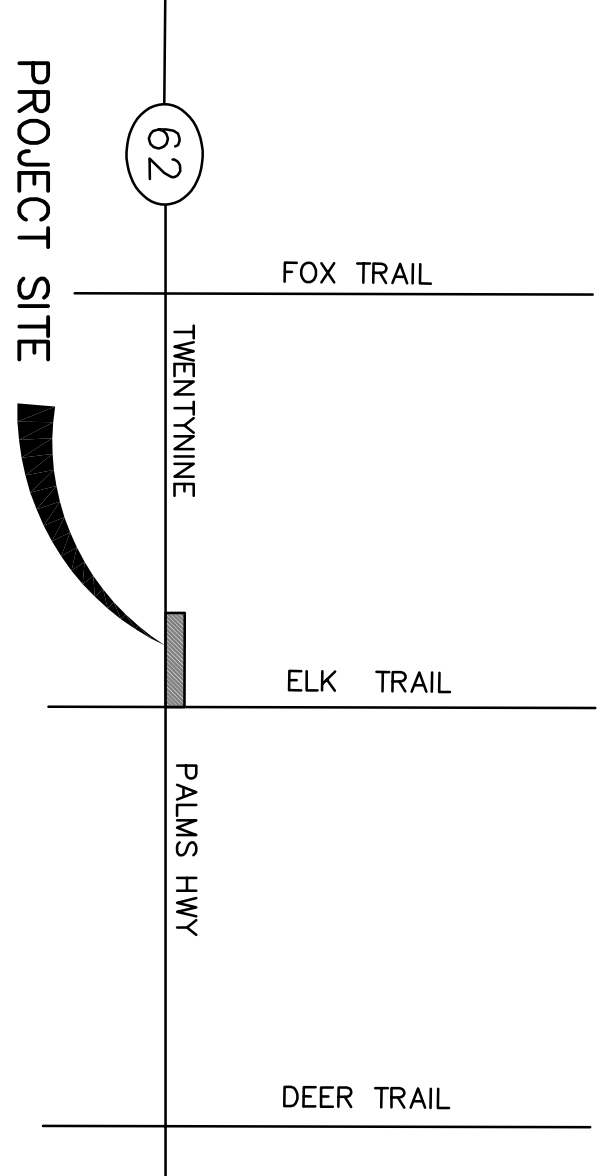
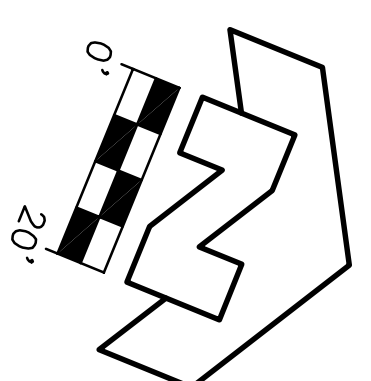
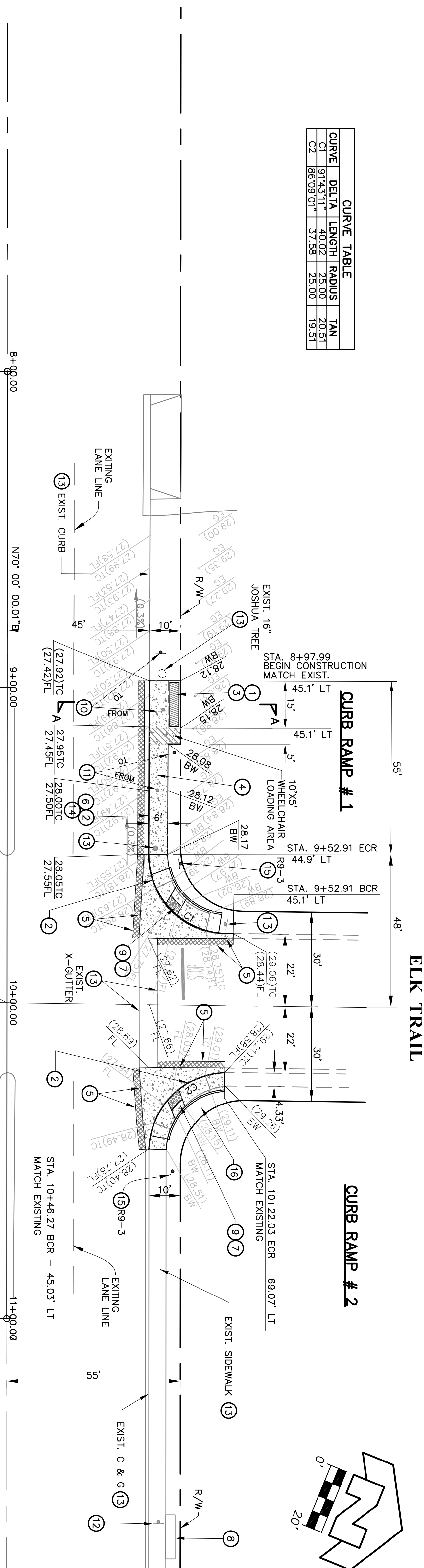
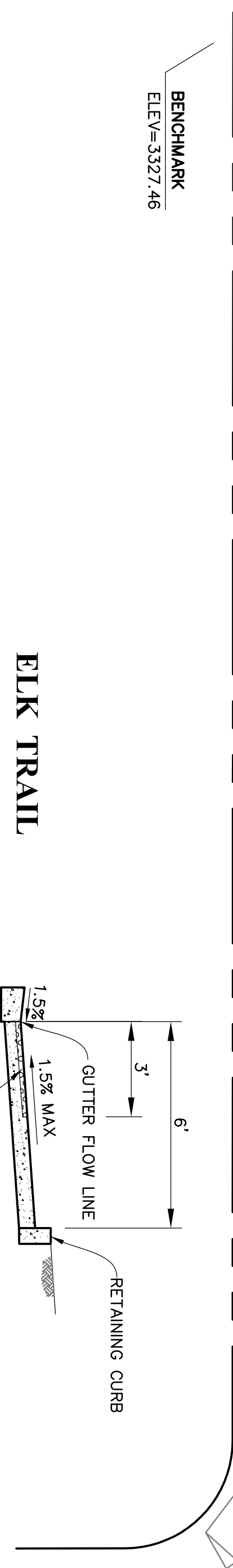

SECTION B-B
NOT TO SCALE

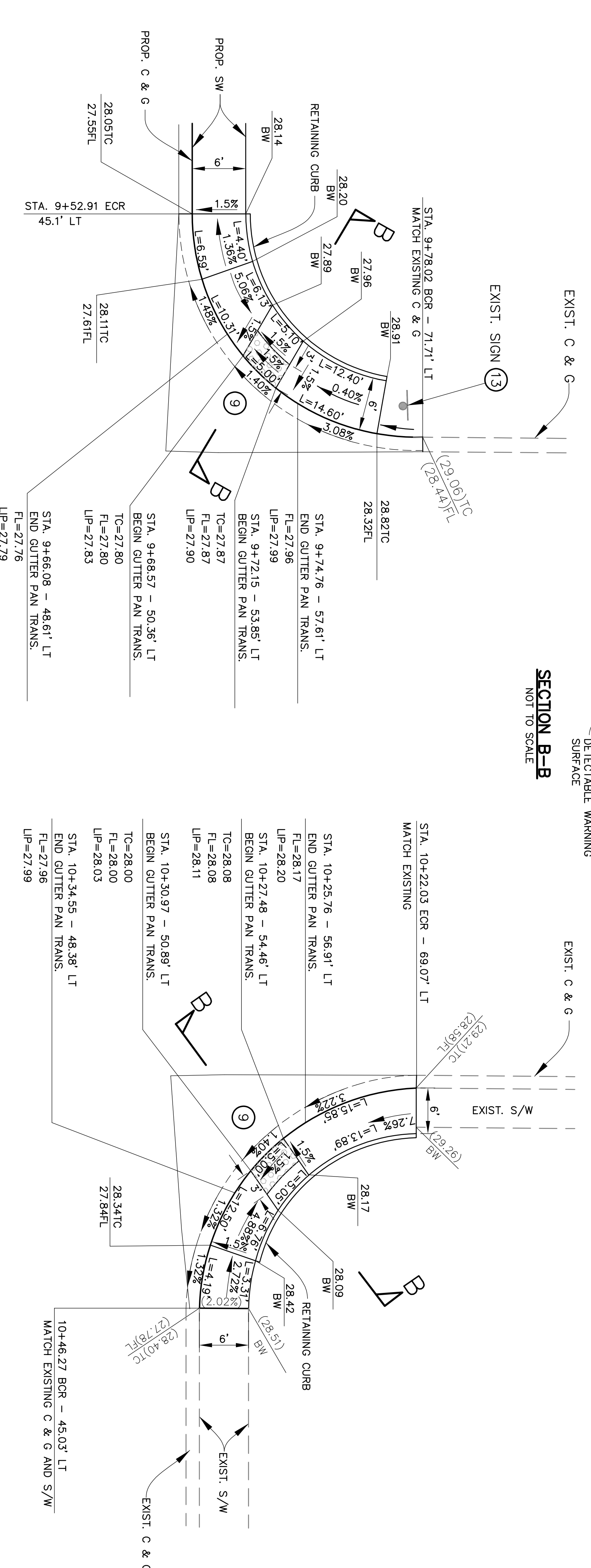

CONSTRUCTION NOTES:

- 1 6" THICK CONCRETE BUS SHELTER PAD WITH W/MF 6X6 WICKWIRE MESH AT MID HEIGHT
- 2 6" CURB & GUTTER PER CALTRANS STD. PLAN A87A, TYPE A2-6
- 3 INSTALL MBTA FURNISHED BUS SHELTER, BENCH, AND TRASH RECEPTACLE
- 4 4" THICK CONCRETE SIDEWALK PER SBORO STD. 109, TYPE C
- 5 SAWCUT AND REMOVE EXISTING AC PAVEMENT (2" MIN), REPLACE WITH FULL DEPTH AC, THICKNESS TO MATCH EXISTING
- 6 SAWCUT AND REMOVE EXISTING AC CURB
- 7 SAWCUT AND REMOVE EXISTING CONCRETE CURB RAMP, CURB & GUTTER, AND SPANDREL
- 8 REMOVE EXISTING BUS SHELTER, BENCH, AND TRASH RECEPTACLE
- 9 CONCRETE CURB RAMP PER CALTRANS STD. A88A, CASE C WITH RETAINING CURB AND SPANDREL
- 10 RELOCATE SPEED SIGN AND POST
- 11 RELOCATE BUS STOP SIGN AND POST
- 12 REMOVE BUS STOP SIGN AND POST
- 13 PROTECT IN PLACE
- 14 PAINT NEW CURB WITH RED PAINT PER CALTRANS STD. SPECS SECTION 84-2
- 15 INSTALL R9-3 SIGN & POST
- 16 REMOVE EXISTING SHRUB AS NECESSARY

QUANTITY:

60	SF
55	LF
1	EA
326	SF
304	SF
55	LF
2	EA
1	EA
1	EA
55	LF
4	EA

NOTE:

FOR ACCURATE RIGHT OF WAY DATA, CONTACT RIGHT OF WAY ENGINEERING AT THE DISTRICT OFFICE.
ESTIMATED WORKING DAYS: 20 DAYS

BENCHMARK:

AT YUCCA VALLEY POST OFFICE, IN TOP OF THE CONCRETE FLAG POLE BASE AT THE NORTH CORNER OF THE POST OFFICE, 151 FT. NORTHEAST OF THE CENTERLINE OF FOX TRAIL, 58 FT. SOUTHEAST OF THE CENTERLINE OF HIGHWAY, 13.5 FT. SOUTHEAST OF THE SOUTHEAST CURB OF HIGHWAY, THE MARK IS 1 FT. ABOVE HIGHWAY.
ELEVATION: 3327.46

LEGEND:

BW	BACK OF WALK
TC	TOP OF CURB
FL	FLOW LINE
FG	FINISH GRADE
FS	FINISH SURFACE
EG	EDGE OF GUTTER
LT	LEFT
BM	BENCHMARK
S/W	SIDEWALK

CURB RAMP # 1

CURB RAMP # 2

Underground Service Alert
Call: TOLL FREE
1-800
227-2600
TWO WORKING DAYS BEFORE YOU DIG

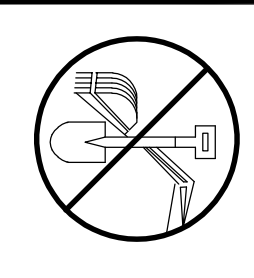

CALTRANS PERMIT # 08-19-N-BS-0680
MORONGO BASIN TRANSIT AUTHORITY
BUS STOP AND SHELTER
TWENTYNINE PALMS HWY (SR-62) AND ELK TRAIL
SCALE: 1"=20'
SHEET 1 OF 2

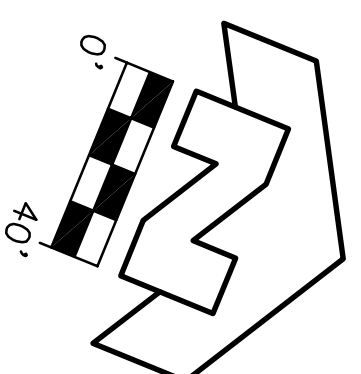

ELK TRAIL
SPEED LIMIT = 25 MPH

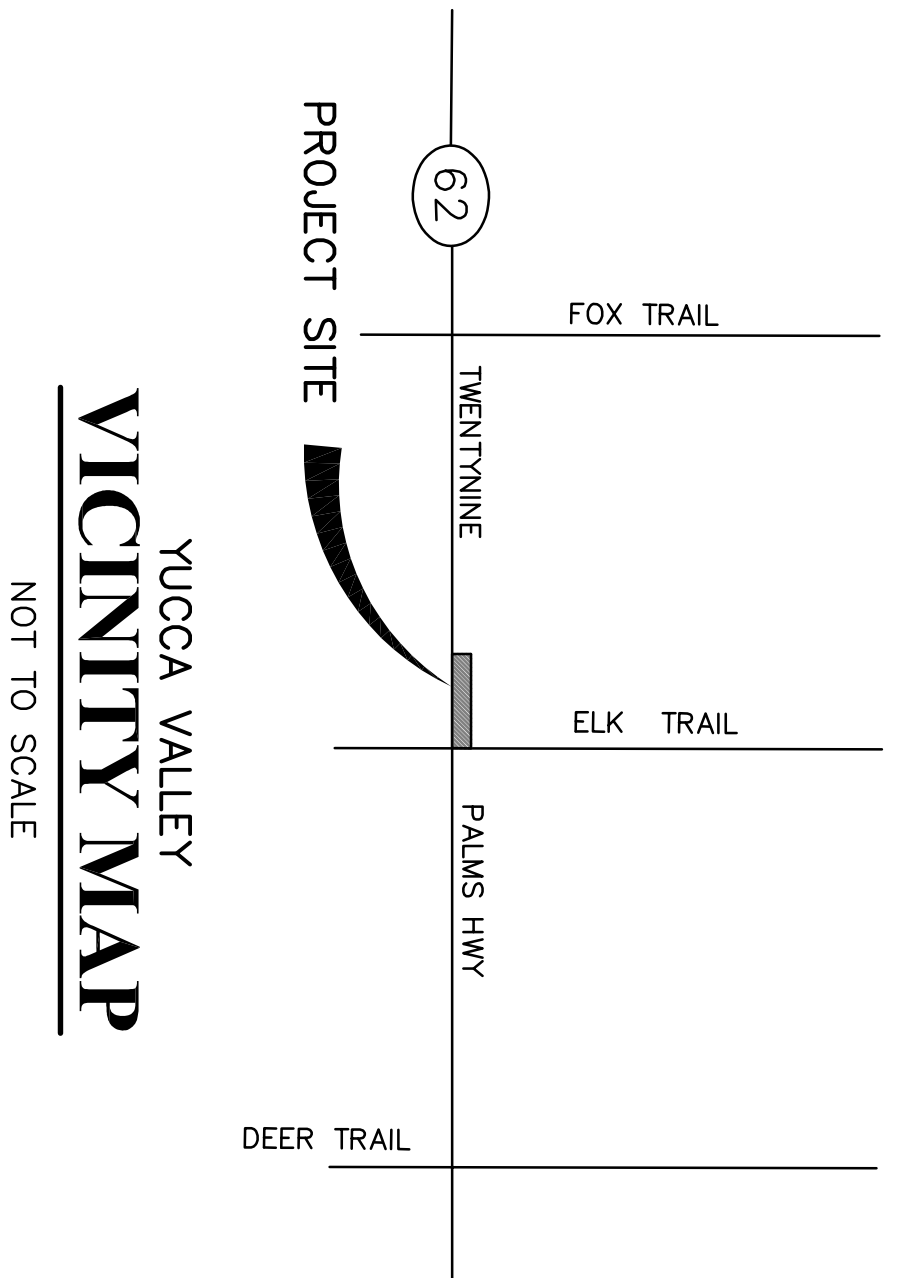
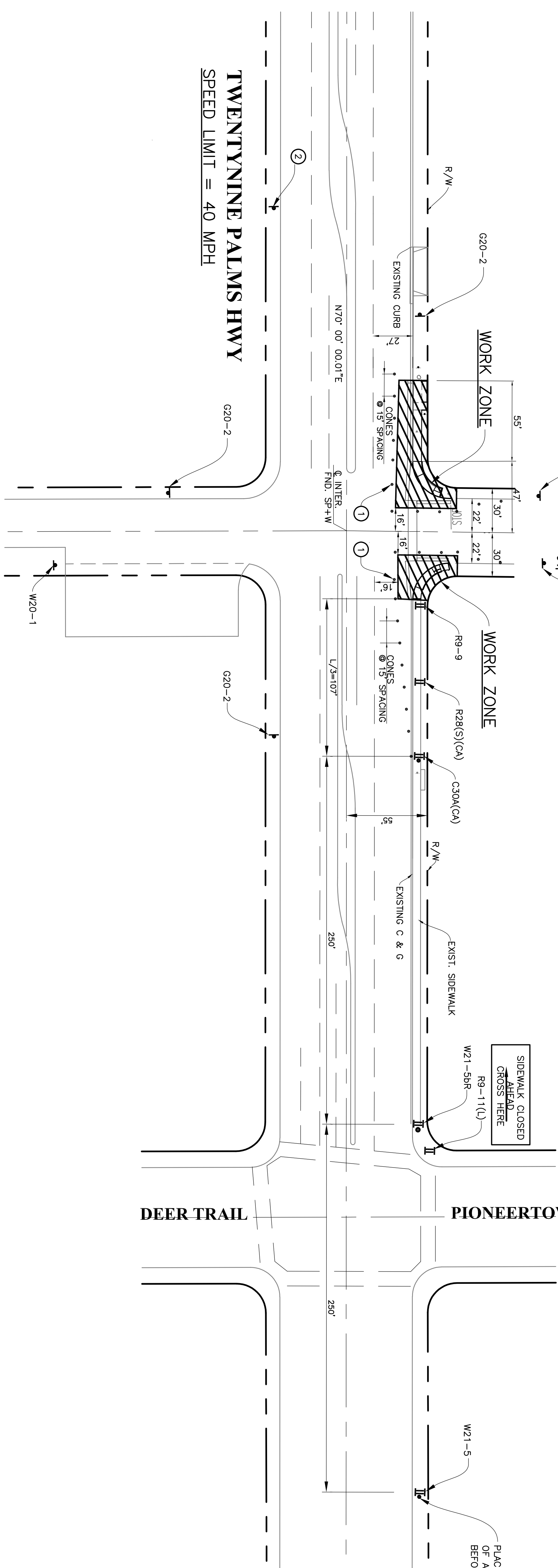

TRAFFIC CONTROL NOTES:
① INSTALL DELINEATORS (TRAFFIC CONES) AT 15' ON CENTER

- LEGEND:**
- TRAFFIC CONES SIGN
 - ▬ TYPE II BARRICADE WITH SIGN
 - ▨ WORK ZONE

NOTE:
CONTRACTOR TO PROVIDE A TEMPORARY FLAGMAN TO DIRECT PEDESTRIAN TRAFFIC SAFELY THROUGH AND AROUND THE WORK ZONE.

NOTE:
FOR ACCURATE RIGHT OF WAY DATA, CONTACT RIGHT OF WAY ENGINEERING AT THE DISTRICT OFFICE.
ESTIMATED WORKING DAYS: 20 DAYS

CALTRANS PERMIT #

MORONGO BASIN TRANSIT AUTHORITY
TRAFFIC CONTROL PLAN
TWENTYNINE PALMS HWY (SR-62) AND ELK TRAIL

SCALE: 1"=40' SHEET 2 OF 2

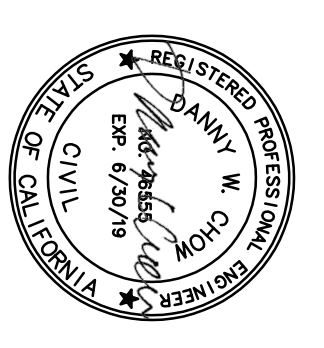

Underground Service Alert
Call: TOLL FREE
1-800
227-2600
TWO WORKING DAYS BEFORE YOU DIG