

**SECTION A-A**  
NOT TO SCALE

CONSTRUCTION NOTES:	QUANTITY:
1 6" CURB PER CALTRANS STD PLAN 887A, TYPE B1-6 CURB	121 LF
2 SAWCUT AND REMOVE EXISTING AC CURB	130 LF
3 INSTALL MBTA FURNISHED BUS STOP SIGN	1 EA
4 8" THICK CONCRETE BUS BAY, PROVIDE CONSTRUCTION JOINT AT 45' MAX SPACING AND WEAKENED PLANE JOINT AT 15' MAX SPACING, PER GREENBOOK SPECS SECTIONS 301-1 & 302-6	754 SF
5 SAWCUT AND REMOVE EXISTING AC PAVEMENT 3.5' WIDE, REPLACE WITH FULL DEPTH AC, THICKNESS TO MATCH EXISTING (2" WIDE)	455 SF CUT 280 SF FILL
6 INSTALL MBTA FURNISHED BUS SHELTER, BENCH, AND RECEPTACLE	2 EA
7 4" THICK CONCRETE SIDEWALK (WIDTH MEASURED FROM BACK OF CURB TO BACK OF WALK) PER SBORD STD. 109, TYPE C	580 SF
8 6" THICK CONCRETE BUS SHELTER PAD WITH WWF 6X6 W/OXWIO WIRE MESH AT MID HEIGHT	120 SF
9 PROTECT IN PLACE	1 LS
10 RELOCATE EXISTING DOUBLE POST GUIDE SIGN (FINAL LOCATION TO BE DETERMINED BY CALTRANS INSPECTOR)	1 EA
11 6" WIDE RETAINING CURB, 10" MAX HEIGHT	50 LF
12 PAINT NEW CURB WITH RED PAINT PER CALTRANS STD. SPECS SECTION 84-2	131 LF
13 5' CURB TRANSITION PER DETAIL	10 LF

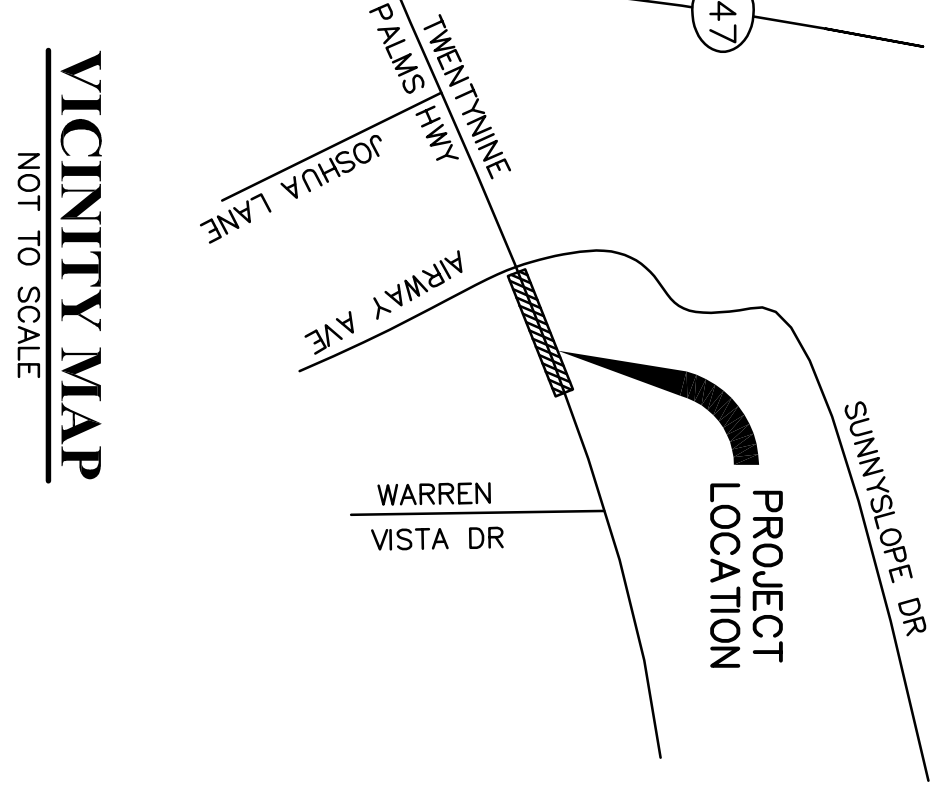

**TWENTYNINE PALMS HWY**

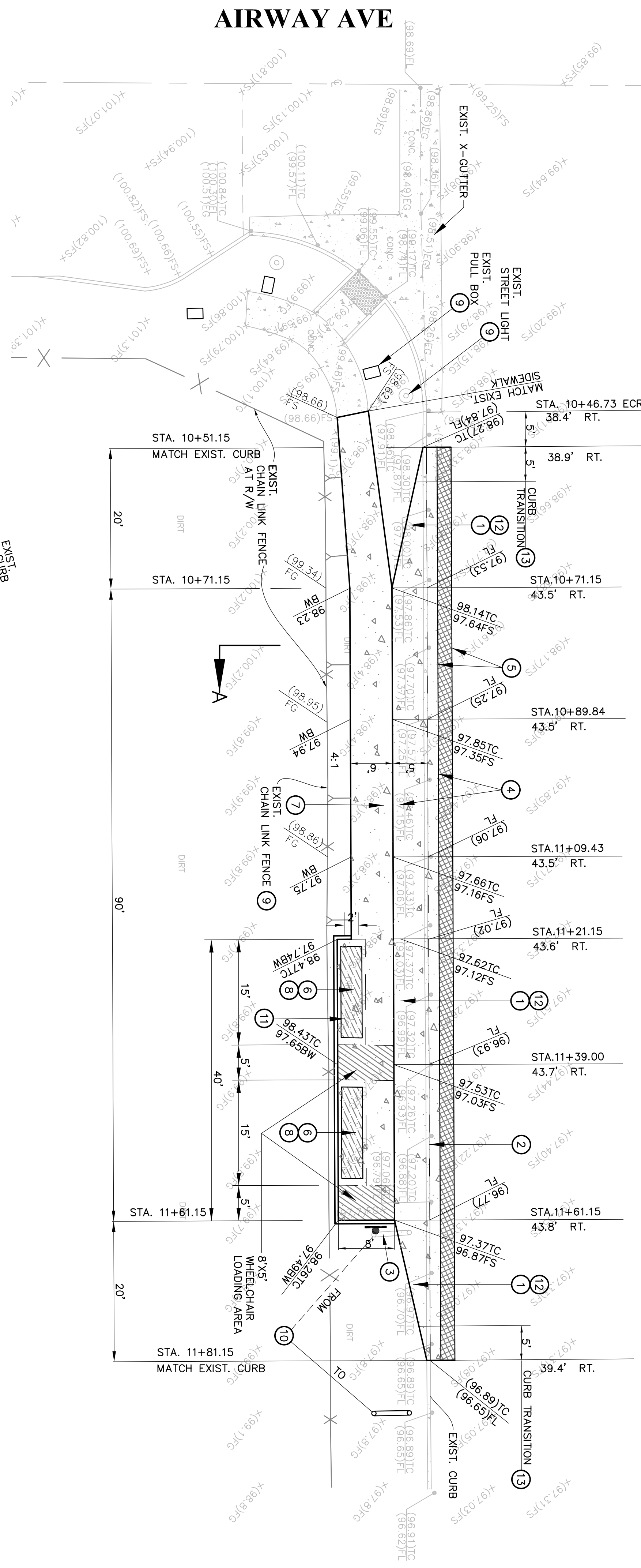

**AIRWAY AVE**

Underground Service Alert  
Call: TOLL FREE  
1-800  
227-2600  
TWO WORKING DAYS BEFORE YOU DIG

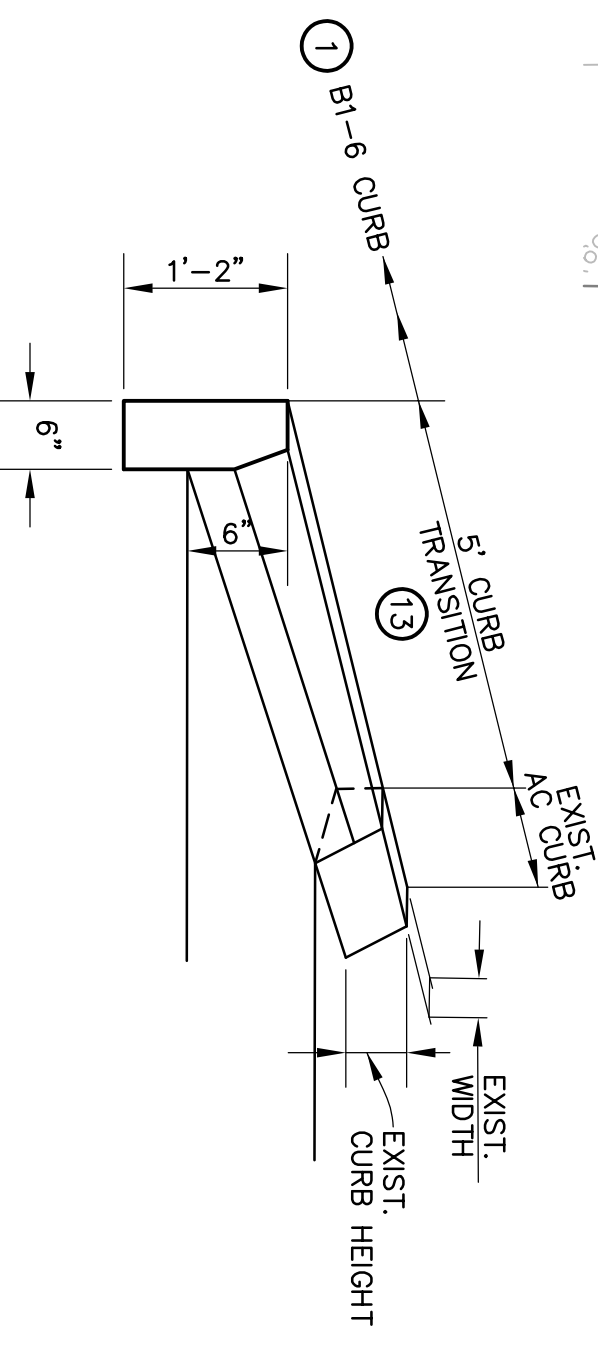

**CURB TRANSITION DETAIL**  
FROM EXIST. AC CURB TO NEW B1-6 CURB  
NOT TO SCALE

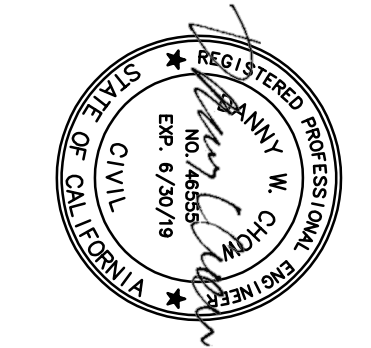

**MORONGO BASIN TRANSIT AUTHORITY**  
BUS TURNOUT AND SHELTERS  
**TWENTYNINE PALMS HWY (SR-62) AND AIRWAY AVENUE**  
SCALE: 1"=10'  
SHEET 1 OF 1

CALTRANS PERMIT # 08-18-N-BS-0179  
04-02-2018

NOTE:  
FOR ACCURATE RIGHT OF WAY DATA, CONTACT RIGHT OF WAY  
ENGINEERING AT THE DISTRICT OFFICE.  
ESTIMATED WORKING DAYS: 20 DAYS

LEGEND:  
BW BACK OF WALK  
TC TOP OF CURB  
FL FLOW LINE  
FG FINISH GRADE  
FS FINISH SURFACE  
EG EDGE OF GUTTER  
RT RIGHT  
STA STATION  
TBM TEMPORARY BENCHMARK

TEMPORARY BENCHMARK:  
C/L INTERSECTION TWENTYNINE PALMS HWY  
AND AIRWAY AVENUE  
ASSUMED ELEV. = 100.00

